

KITITITAS COUNTY COMMUNITY DEVELOPMENT SERVICES

411 N. Ruby St., Suite 2, Ellensburg, WA 98926

CDS@CO.KITITITAS.WA.US

Office (509) 962-7506

"Building Partnerships – Building Communities"

AFFIDAVIT OF POSTING

Effective July 19, 2007, Kittitas County Code requires all project actions that are not processed administratively to have a notice posted at the site of the project. Per KCC 15A.03.110 the following applies:

1. The applicant shall post the subject property with signs as required by Community Development Services.
2. Signs shall be posted on each road frontage on the subject property and shall be clearly visible and accessible.
3. Signs shall be posted and on-site prior to the issuance of a Notice of Application.
4. The sign shall be posted in a sturdy manner to remain on-site until fifteen days after the expiration of the Notice of Decision appeal period. It shall be the responsibility of the applicant to properly dispose of the sign.
5. At the time of development application, Community Development Services will identify the number of signs needed and the general location of each sign on the subject property.
6. It shall be the responsibility of the applicant to place the structure on which the sign will be posted on site. At such time the structure and sign is in place, the applicant shall contact Community Development Services.

DATE: February 18, 2021	PLANNER: Kelly Bacon

PROJECT NAME: Swiftwater Storage Conditional Use	FILE NUMBER: CU-20-00006
---------------------------------------------------------	---------------------------------

PLEASE COMPLETE THE FOLLOWING:

I, Jasha Mitchell, certify that I am the landowner and/or authorized agent responsible for the posting of this land use project site and further certify that the site has been posted as required by Kittitas County Code. I understand that the required posting period begins immediately and ends 15 days after the ending of the appeal period on the Notice of Decision and the sign(s) will be posted at the site until this time. **Failure to post the site and return this form to Community Development Services in a timely manner will result in a delay of the application review for the project.**

Signature

Feb-19-2021
Date

Please return the above certification to CDS; Fax at 509-962-7682; or mail to; Community Development Services, 411 North Ruby Street, Suite 2, Ellensburg, WA 98926.

For Staff Use Only:
Received _____

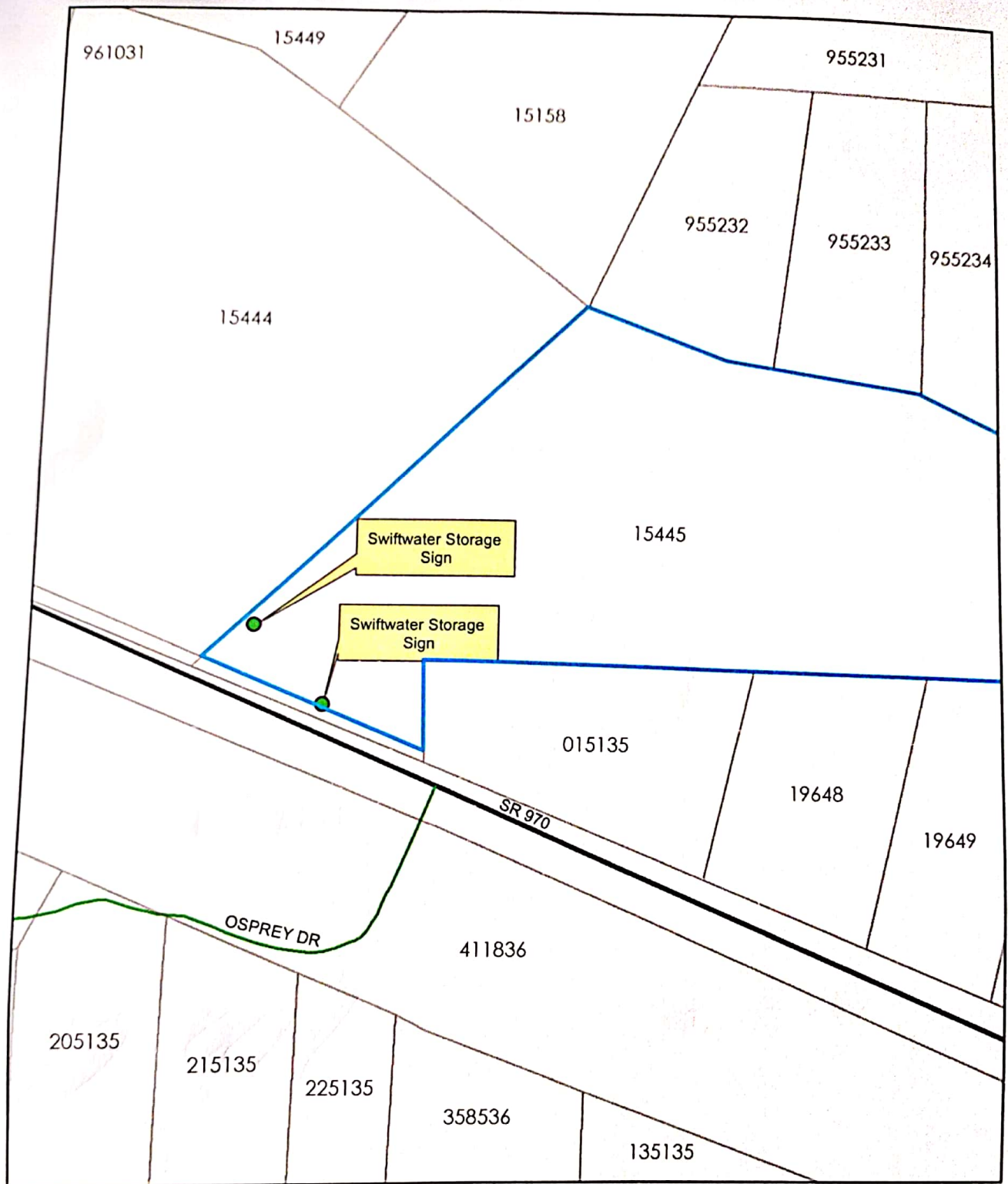

CU-20-00006
Swiftwater Storage

Sign Posting Map



From: [Josh Mitchell](#)
To: [Kelly Bacon \(CD\)](#)
Subject: Re: CU-20-00006 Swiftwater Storage - Deemed Complete
Date: Friday, February 19, 2021 12:47:16 PM





Hello Kelly, here are the photos of the two signs posted on the property. Please let me know if this is sufficient I also have a timestamp on them, I'm happy to come drop off the paperwork this afternoon or I can photocopy and send you back a copy if you do not need the original. Just let me know either way is fine.

Thank you

Get [Outlook for Android](#)

From: Kelly Bacon (CD) <kelly.bacon.cd@co.kittitas.wa.us>
Sent: Thursday, February 18, 2021 2:33:56 PM
To: 'Spencer Parr' <spencer@washingtonlawcenter.com>
Cc: 'Josh Mitchell' <JMitchell6686@hotmail.com>
Subject: CU-20-00006 Swiftwater Storage - Deemed Complete

Good afternoon,

Attached please find correspondence in regards to conditional use application CU-20-00006. If a hard copy of the letter is found necessary for your record, please let me know and I will place one in the mail as soon as I am able to do so. Please contact me directly with any questions.

Thank you,

Kelly Bacon

Planner I

Kittitas County Community Development Services

411 N. Ruby Street, Ste 2

Ellensburg, WA 98926

Office: (509) 962-7539

Kelly.bacon.cd@co.kittitas.wa.us

Please Note: In an effort to mitigate the spread of COVID-19 and the Governor's "Safe Start" reopening plan, Kittitas County Community Development Services is currently in Phase 3 and is open to the public in a limited capacity. At this time many of us are on a rotating schedule working from home and in the office; during this time I will do my best to respond to you as promptly as possible.

The information transmitted by this email is intended only for the person or entity to which it is addressed. This email may contain confidential and/or privileged material. If you are not the intended recipient of this message, be aware that any use, review, retransmission, distribution, or reproduction is strictly prohibited. If you received this in error, please contact the sender immediately and delete the material from all devices.
message id: 38eb45916c6dcbdac24bb8719d004a14